



# GROWN-UP TRAVEL SHOW

28 – 29 March 2020  
 Harrogate Convention Centre  
[grownuptravelshow.com](http://grownuptravelshow.com)



**EARLY BOOKINGS**  
 (Expires 31 March 2019)  
**SPACE ONLY:**  
 \*We require \_\_\_\_\_ m<sup>2</sup> of space only at £275 per m<sup>2</sup> at a cost of £ \_\_\_\_\_ + VAT.  
 \*Delete as applicable.  
**SPACE & SHELL SCHEME:**  
 \*We require \_\_\_\_\_ m<sup>2</sup> of space, plus shell scheme at £295 per m<sup>2</sup> at a cost of £ \_\_\_\_\_ + VAT.  
 (Shell Scheme consists of side and back walls in octanorm with infill panels, grid ceiling, full carpeting, 300mm fascia with company name and stand number!)

**RATE CARD**  
**SPACE ONLY:**  
 \*We require \_\_\_\_\_ m<sup>2</sup> of space only at £295 per m<sup>2</sup> at a cost of £ \_\_\_\_\_ + VAT.  
 \*Delete as applicable.  
**SPACE & SHELL SCHEME:**  
 \*We require \_\_\_\_\_ m<sup>2</sup> of space, plus shell scheme at £315 per m<sup>2</sup> at a cost of £ \_\_\_\_\_ + VAT.  
 (Shell Scheme consists of side and back walls in octanorm with infill panels, grid ceiling, full carpeting, 300mm fascia with company name and stand number!)

**LATE BOOKINGS**  
 (From 01 September 2019)  
**SPACE ONLY:**  
 \*We require \_\_\_\_\_ m<sup>2</sup> of space only at £315 per m<sup>2</sup> at a cost of £ \_\_\_\_\_ + VAT.  
 \*Delete as applicable.  
**SPACE & SHELL SCHEME:**  
 \*We require \_\_\_\_\_ m<sup>2</sup> of space, plus shell scheme at £335 per m<sup>2</sup> at a cost of £ \_\_\_\_\_ + VAT.  
 (Shell Scheme consists of side and back walls in octanorm with infill panels, grid ceiling, full carpeting, 300mm fascia with company name and stand number!)

- Key**
- Catering & Seating
  - Features
  - Stands - UNSOLD

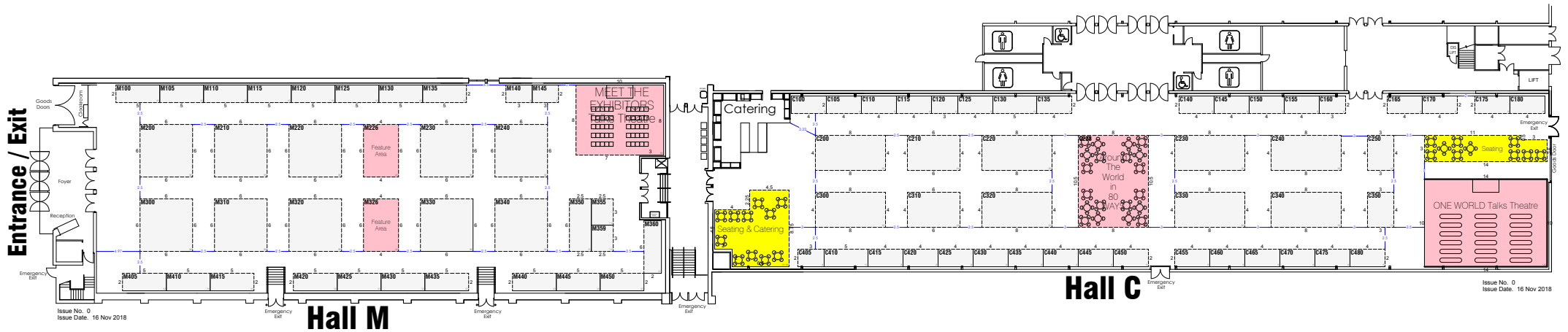

Issue No. 0  
 Issue Date: 16 Nov 2018

Issue No. 0  
 Issue Date: 16 Nov 2018

# Entrance / Exit

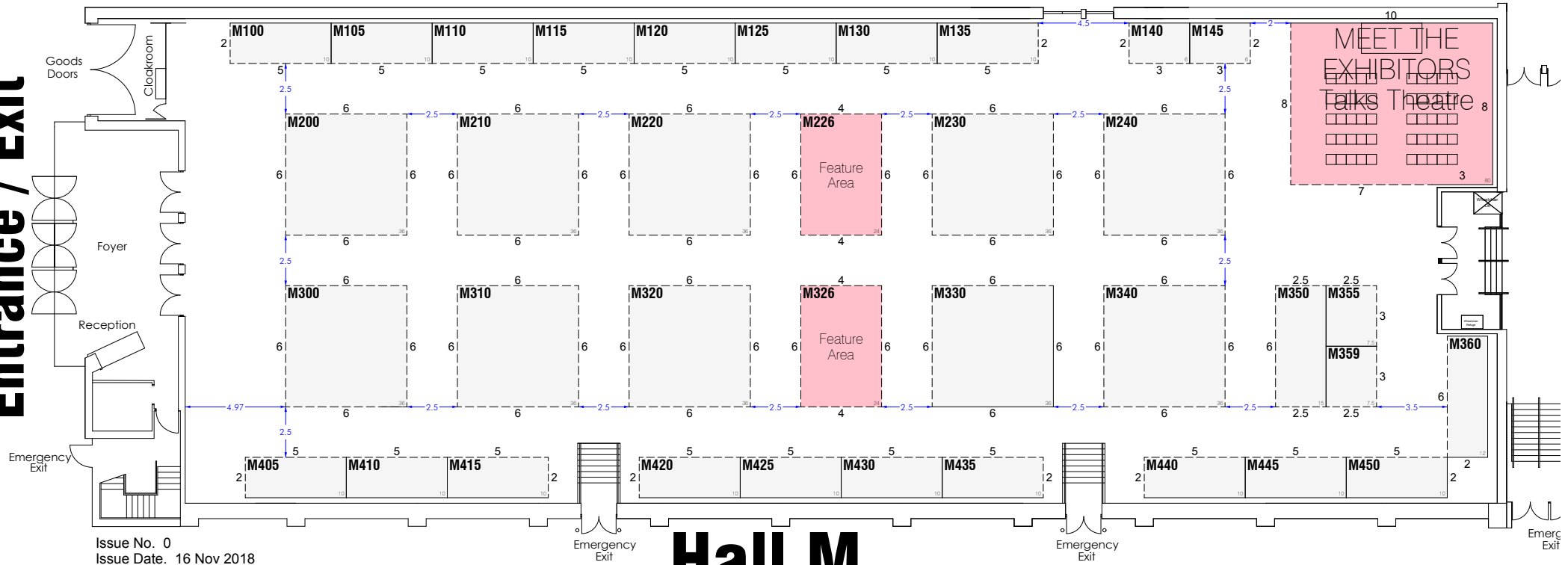

Issue No. 0  
Issue Date. 16 Nov 2018

# Hall M

